

400 / 405 / 410 / 415

GH415M6-B66HST-C GH415M6-B66HBT-C

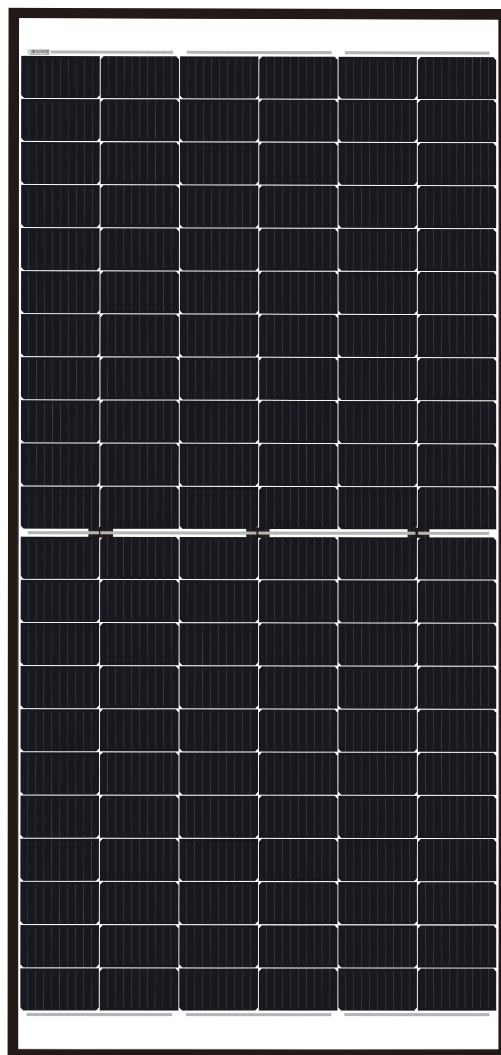

Comfortable profit

Turn carports, greenhouses, roofed in spaces into green power plants.



Reliable

The framed edges reduce the risk of glass breakage and delamination



Versatile

Integration in (existing) greenhouses constructions, carports or various other roofing concepts.



Maintenance and cleaning

With existing greenhouse cleaning methods, sufficient and low cost

Peak Power Warranty

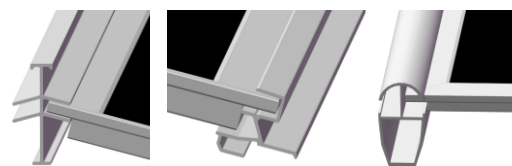
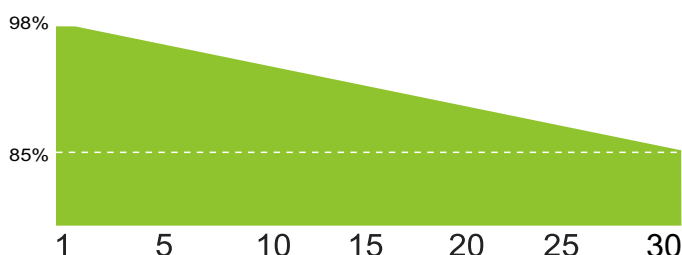

Tier 1 

15 Years Product Warranty

30 Years Peak Power Warranty

Electrical Specifications

Module Type	GH400M6-B66HS/BT-C	GH405M6-B66HS/BT-C	GH410M6-B66HS/BT-C	GH415M6-B66HS/BT-C
Testing Condition	STC	STC	STC	STC
Pmax(W)	400	405	410	415
Imp(A)	10.77	10.86	10.95	11.04
Vmp(V)	37.17	37.33	37.48	37.63
Isc(A)	11.20	11.30	11.40	11.50
Voc(V)	45.67	45.82	45.97	46.12
Module Efficiency	17.86%	18.08%	18.31%	18.53%
Bifaciality:70%±10% STC:AM1.5 1000W/m ² 25°C Measurement uncertainty:±3%				

Bifacial Gain

	Pm(STC)	440W	446W	451W	457W
10%	Pm(STC)	440W	446W	451W	457W
20%	Pm(STC)	480W	486W	492W	498W
30%	Pm(STC)	520W	527W	533W	540W

Mechanical Data

Cell Type	P type Mono-crystalline
Cell Arrangement	132(6x11)
Module Dimensions	2115x1059x12mm
Weight	27kg
Module Structure	Glass/Encapsulant/Glass
Glass Thickness	2.0mm+2.0mm
PV module classification	Class II
Junction Box Rating	IP67/IP68
Cables	4mm ² /(+)60mm;(-)200mm
Connector Type	PV-ZH202B or MC4 (1000V) PV-ZH202B or MC4-EVO 2A(1500V)

Packaging

Pallet dimensions	2210*1127*1230mm
Container	40'HQ
Pieces per Pallet	36
Pieces per Container	770

Temperature Characteristics

Nominal Operating Cell Temperature	42±3°C
Temperature Coefficient of Isc	+0.0487%/°C
Temperature Coefficient of Voc	-0.256%/°C
Temperature Coefficient of Pmax	-0.328%/°C

Maximum Ratings

Operating Temperature	-40°C to +85°C	Maximum Series Fuse Rating	25A
Maximum Load Capacity	Snow 5400Pa/Wind 2400Pa	Number of Diodes	3
Maximum System Voltage	1000V/1500V DC(IEC)		

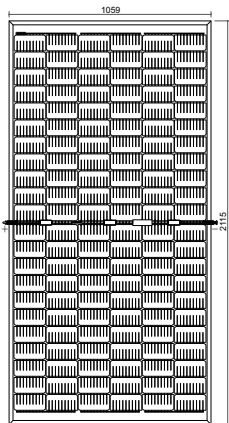

(Back side)
Note:mm

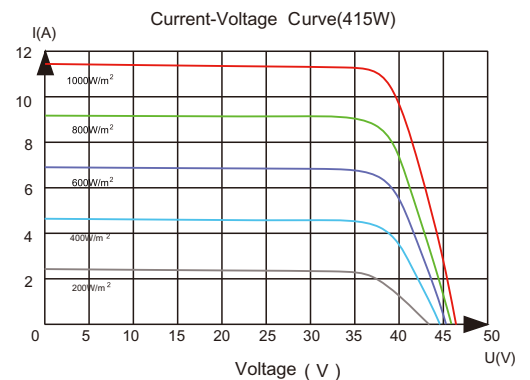
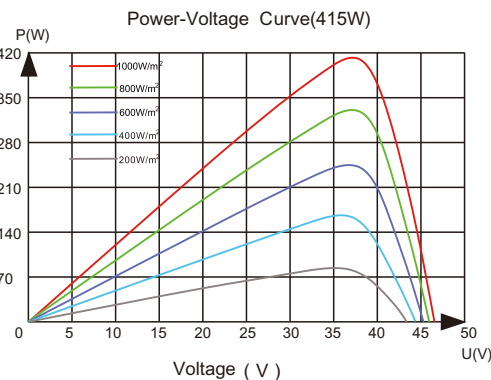

Statement: Due to technological progress, product parameters will be adjusted accordingly; When signing the contract, the latest data of the company shall prevail.